

AIR INLET AND EXHAUST SYSTEM

159-8828 TURBOCHARGER GP

SMCS-1052, 1053

i01900814

NOTE	REF NO	GRAPHIC REF	PART NUMBER	QTY	PART NAME	SEE PAGE
	1	1	6V-1943	12	BOLT-HIGH TEMPERATURE (3/8-16X.125 IN)	
	2	1	2N-2765	8	BOLT-HIGH TEMPERATURE (3/8-16X1.75 IN)	
	3	1	6V-6753	8	BOLT-HIGH TEMPERATURE (3/8X16X1.375 IN)	
	4	1	5M-2894	20	WASHER-HARD (10.2X18.5X2.5MM THK)	
	5	1	121-5736	2	GASKET	
	6	1	207-1382	4	GASKET-EXHAUST	
	7	1	2N-2766	8	LOCKNUT (3/8-16 THD) (HIGH TEMPERATURE)	
CY	8	1	188-4621	2	TURBOCHARGER GP	290
	9	1	188-0471	4	FLANGE-HALF	
	10	1	188-0475	4	FLANGE-HALF	
	11	1	207-1390	2	BELLOWS AS	

C-CHANGE FROM PREVIOUS TYPE
Y-SEPARATE ILLUSTRATION

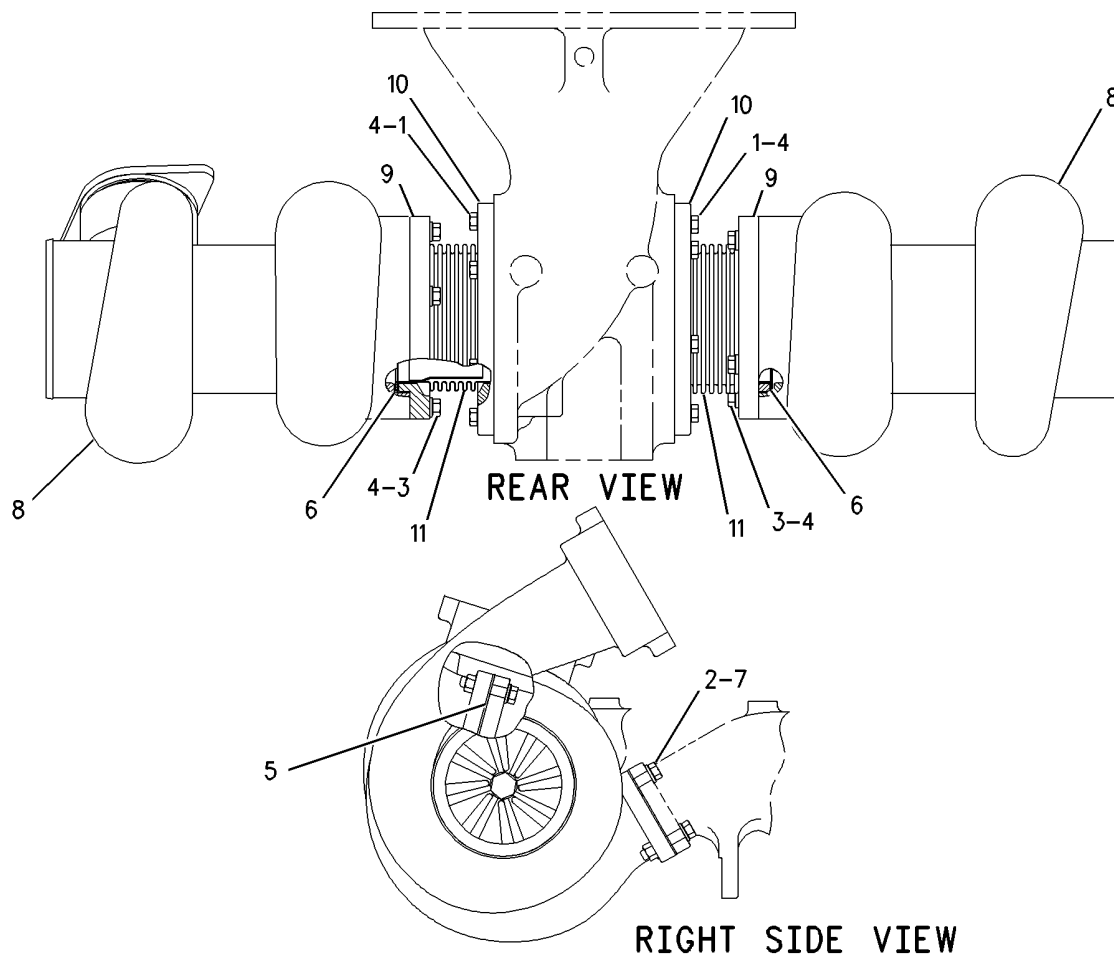

GRAPHIC #1

<END>

g00720946