

- 4 The operator must have easy access to the air filler valve on the top of the tank.
- 5 The operator must have easy access to the fill port on top of the tank.
- 6 Reservoir must be mounted to the bulkhead, wall or post using either bolts or screws.

NOTICE

There are two ports located on the bottom of the reservoir. One is plugged and can be used as a drain port. The other has a filter assembly and is used for connecting to the system. See Figure 11.

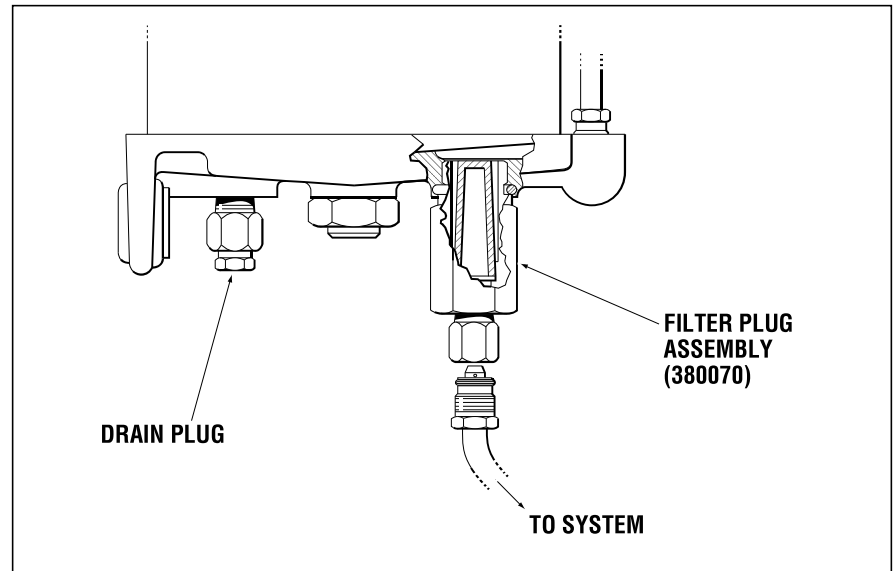

Figure 11. Ports on Bottom of R-04 Reservoir.

MCV-04 Charging Valve Installation

The charging valve should be located in the general vicinity of the reservoir.

- 1 Install appropriate adapters for the tubing used. For port locations see Figure 12.
- 2 Mount the charging valve using two screws or bolts.

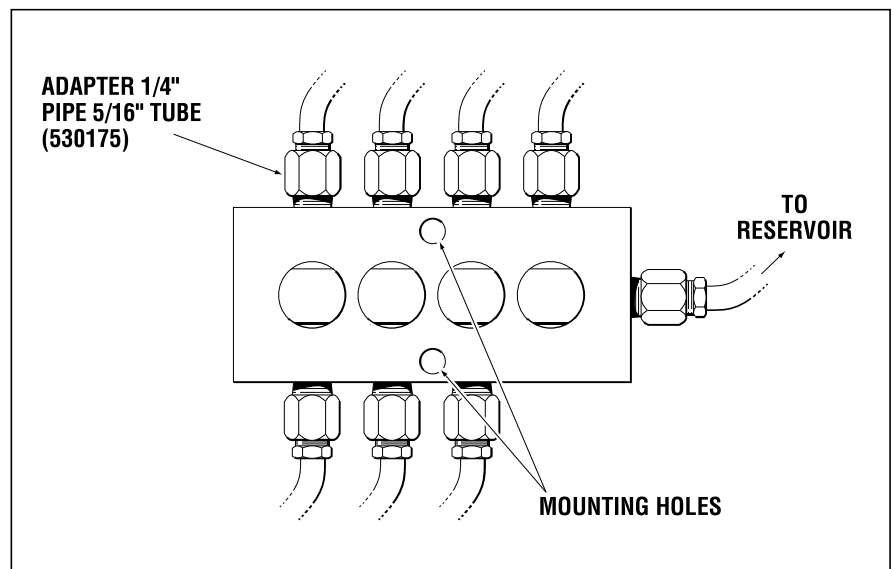

Figure 12. MCV-04 Charging Valve.